

Hawthorne Court | Howley Park Rd | Morley | Leeds | LS27 0BN

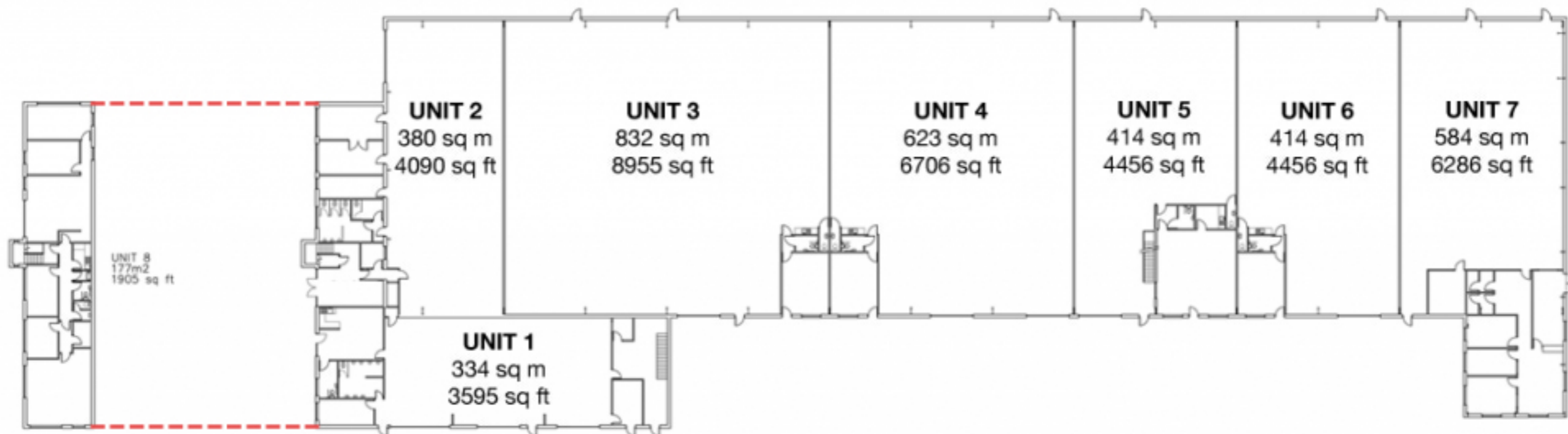

FIRST FLOOR PLAN

GROUND FLOOR PLAN
GROUND FLOOR PLAN



UNIT 8
58 sq m
624 sq ft

Thank you for your interest in Hawthorne Court in Morley

To arrange a viewing or to discuss your requirements, please contact:

Paul Crabtree Bsc (Hons) MRICS

Tel. 0113 270 8100

Mobile. 0773 030 2004

Email. paul.crabtree@abgroup.co.uk

